

Montclair Board of Education

Information for District:

Building History

Boilers

Playgrounds

Roofs

Parking Lots

District Wide Building History

by age / construction date

- 22 Valley Road

- Administration Bldg -1879
- Central Heating – 1931
- Pre-K - Original Bldgs - 1900's, 1930's, Addition 1999, Modular 2002



- Bradford

Original Building -1927

Additions - 1949, 1951, 2005

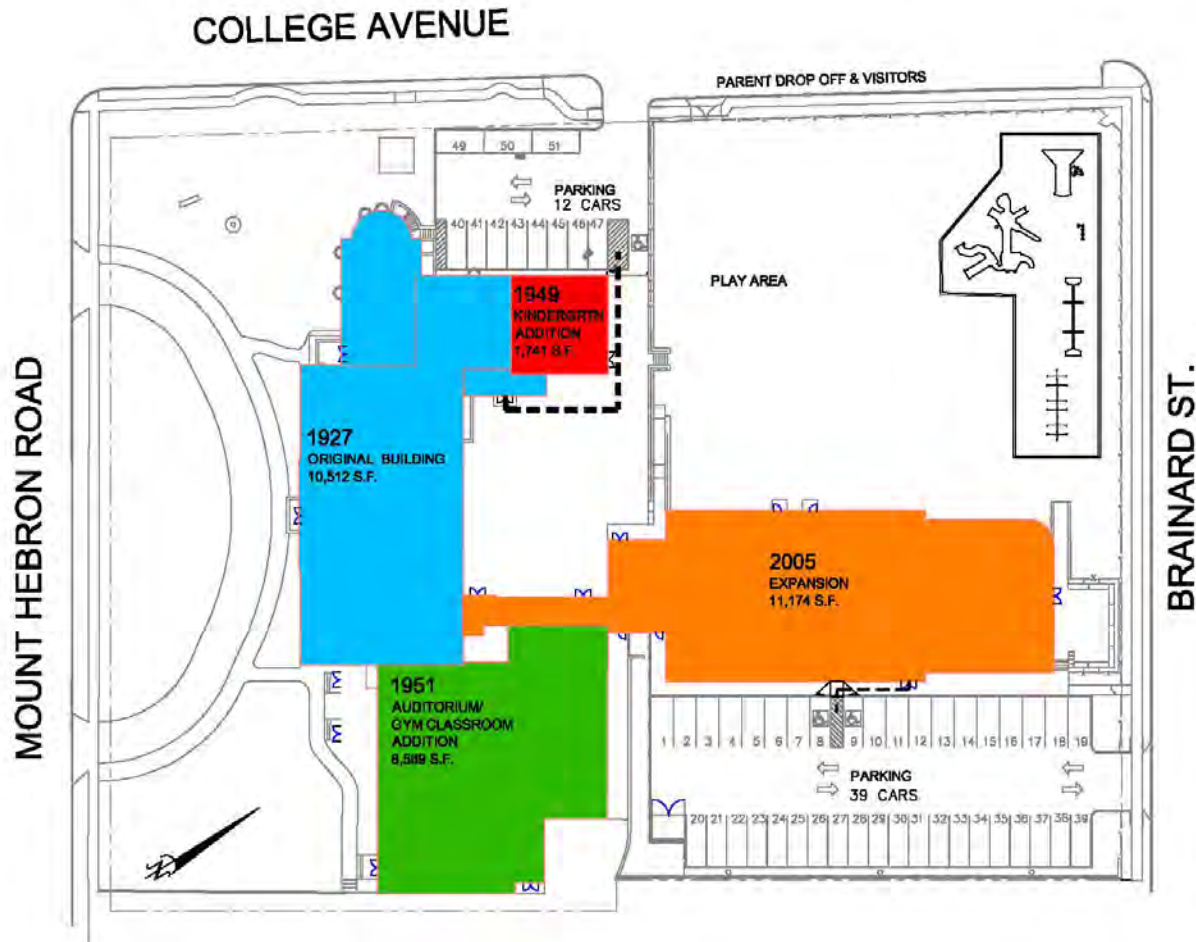

- Charles H. Bullock

- New Building - 2010

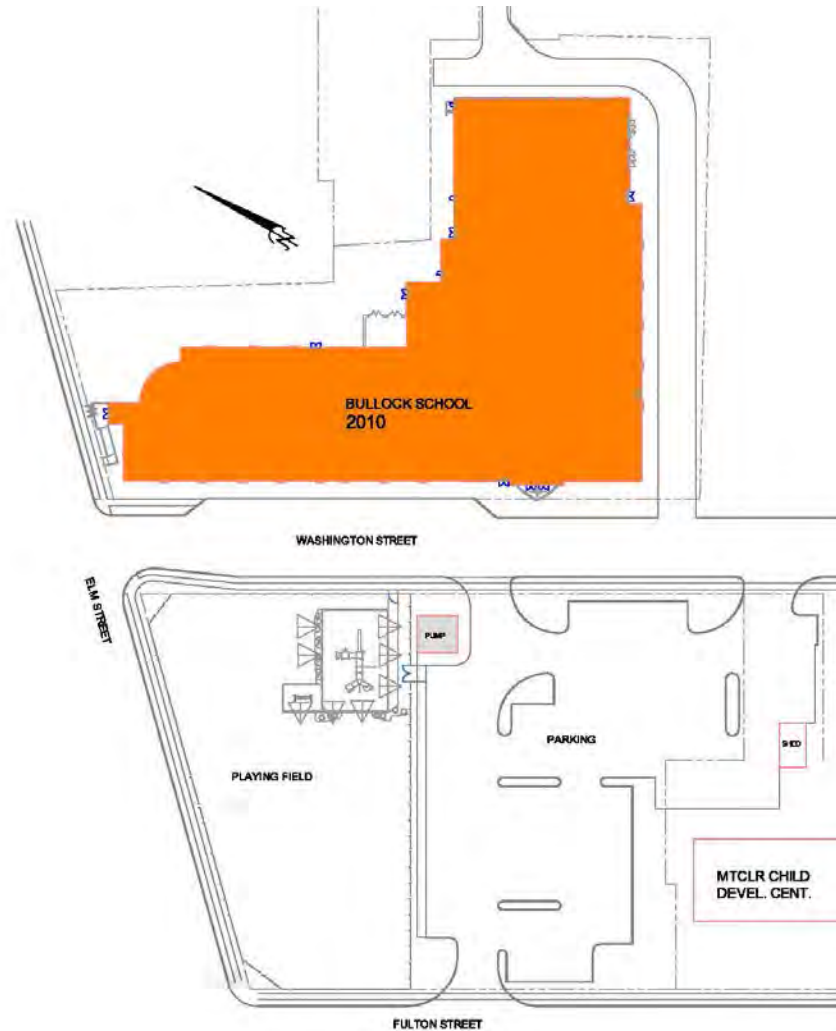

- Edgemont

Original Building -1925

Additions - 1949, 1950

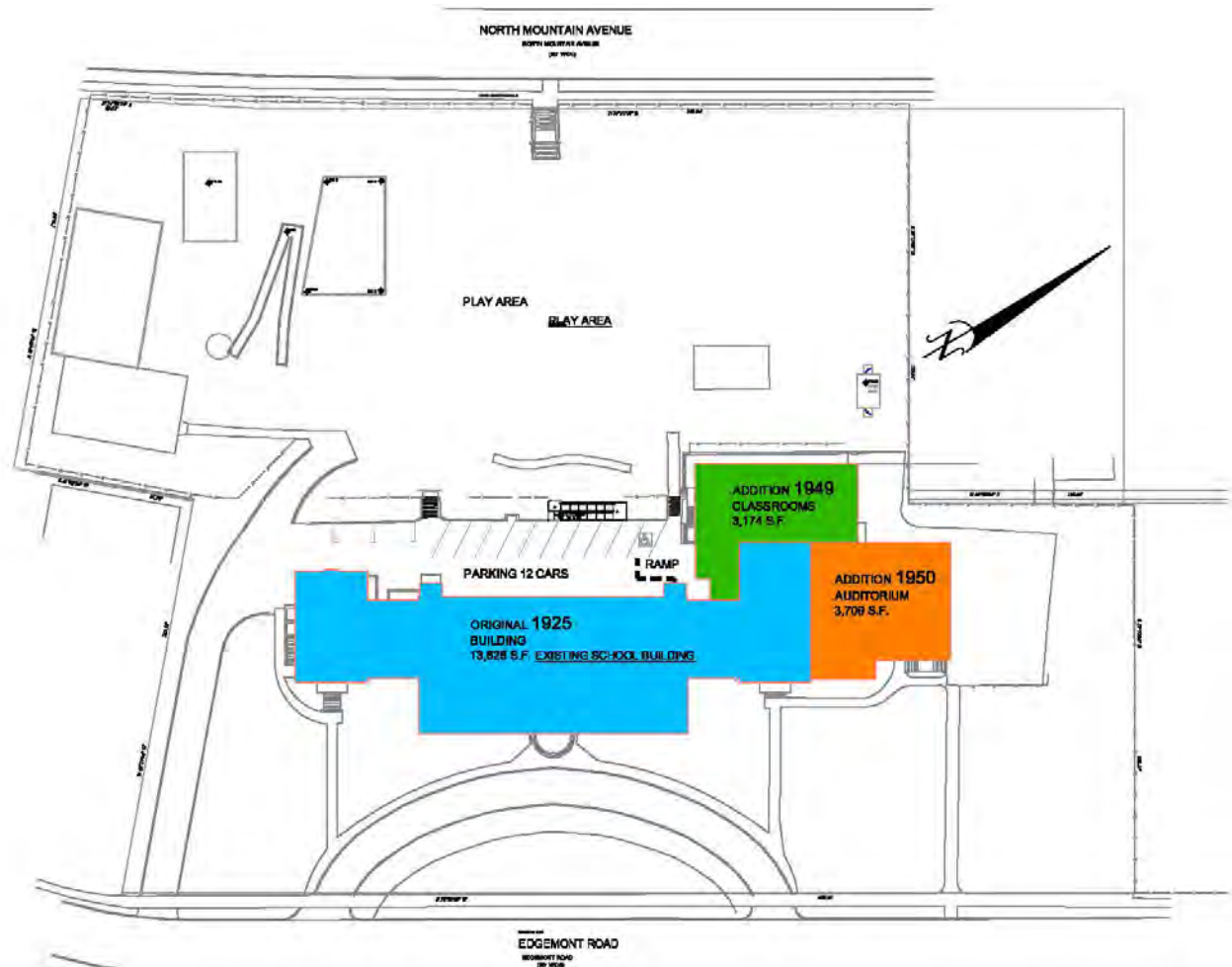

- Glenfield

Original Building -1896

Additions - 1922, 1924, 1928, 1933,1980

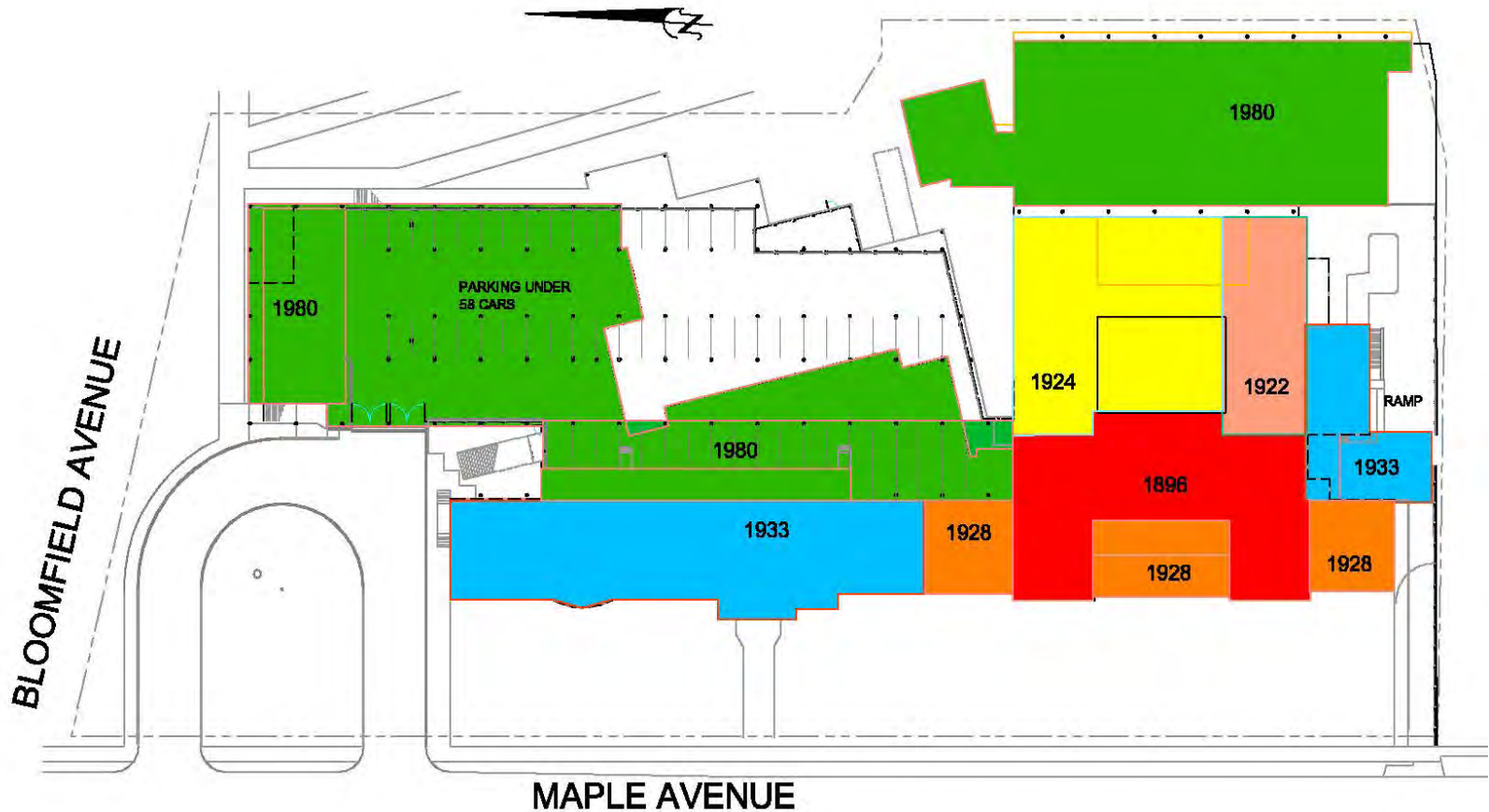

- Hillside

Original Building -1931

Additions - 1950, 2004 (Elevator)

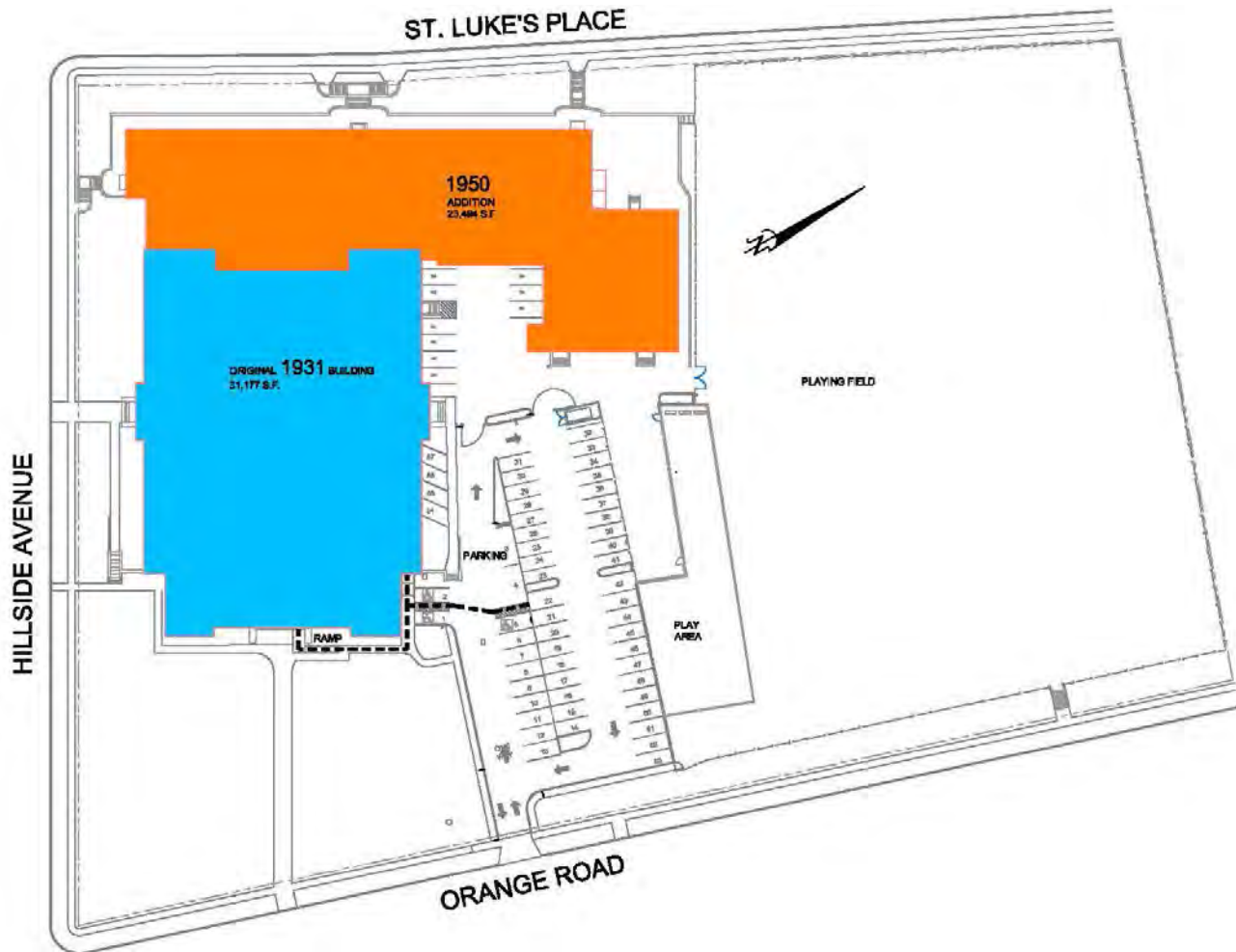

- High School

Original Building -1914

Addition - 1959

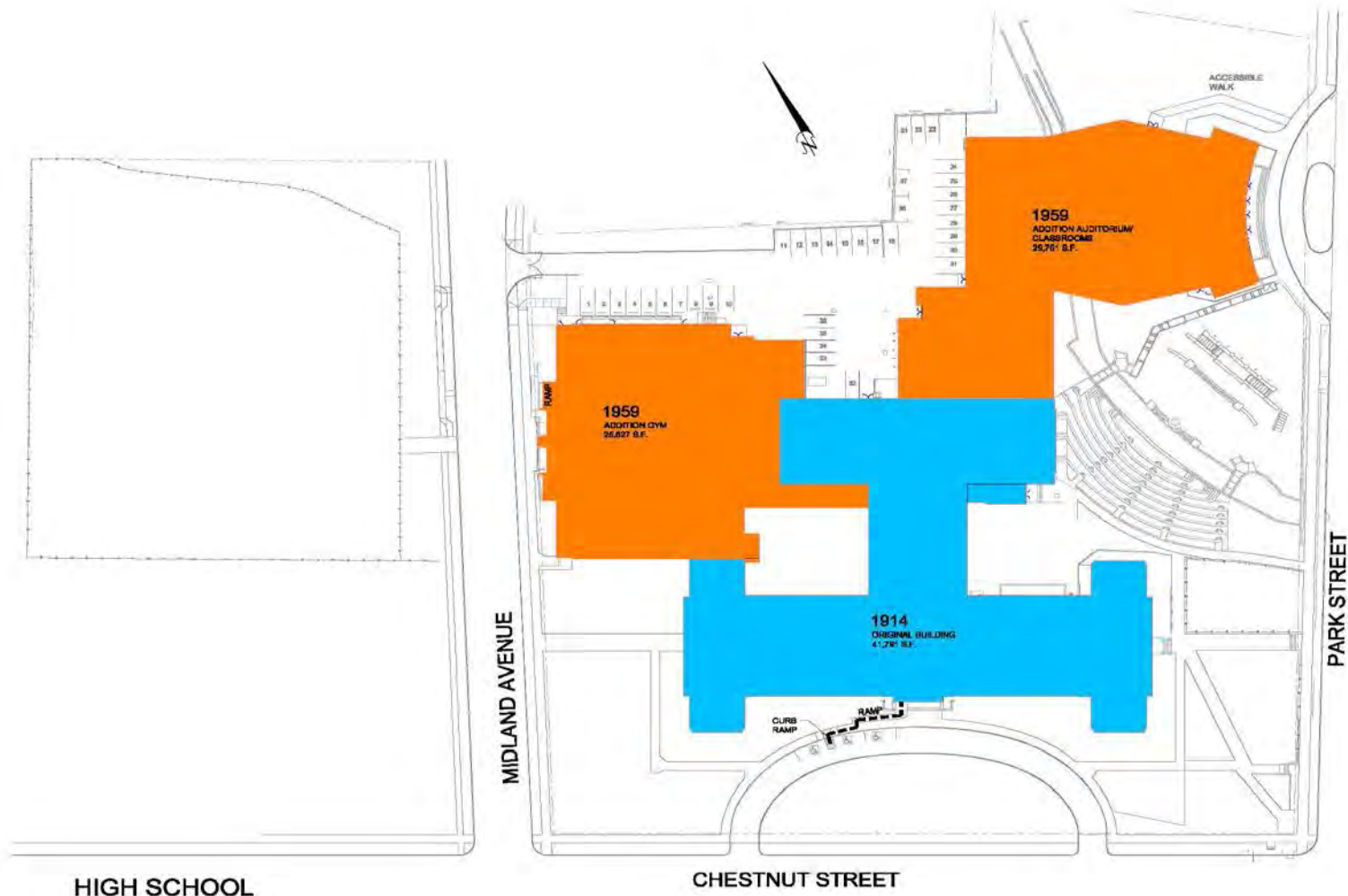

- George Inness

Original Building -1925

Additions - 1928, 2003

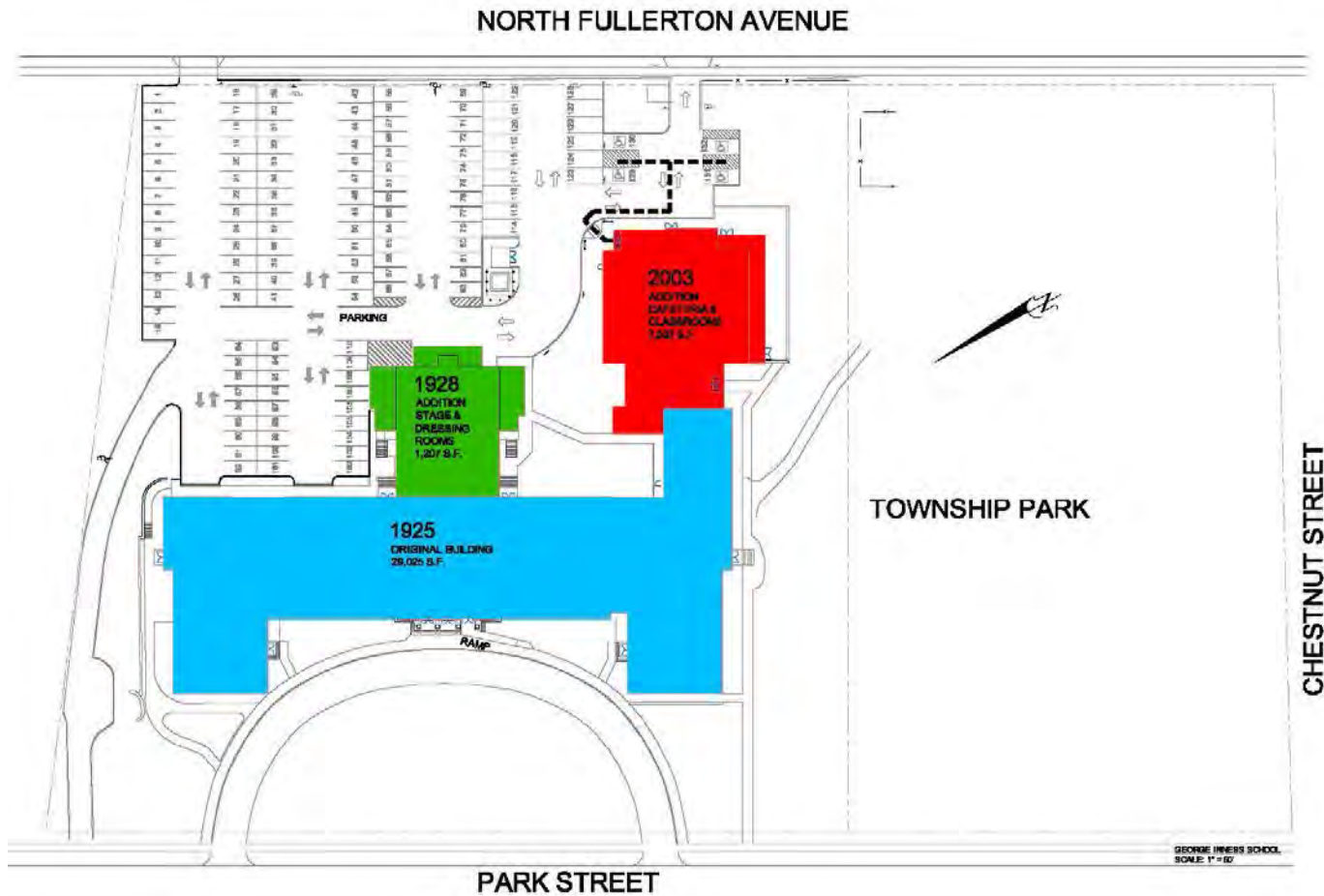

- Mount Hebron

Original Building -1909

Additions - 1920, 1924, 1930, 1972 (Elev.), Greenhouse- 2000

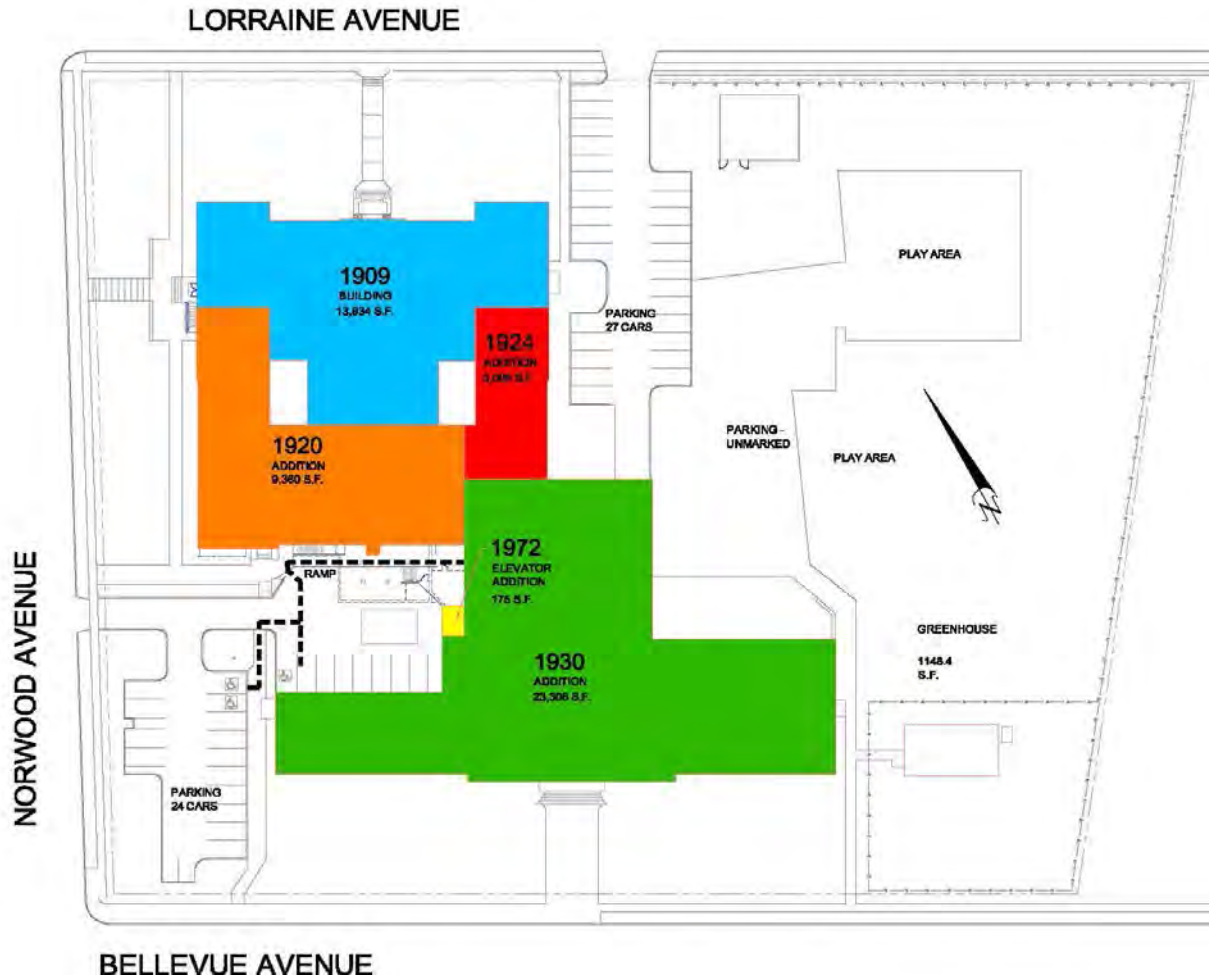

- Northeast

Original Building -1935

Additions - 1957, 2000

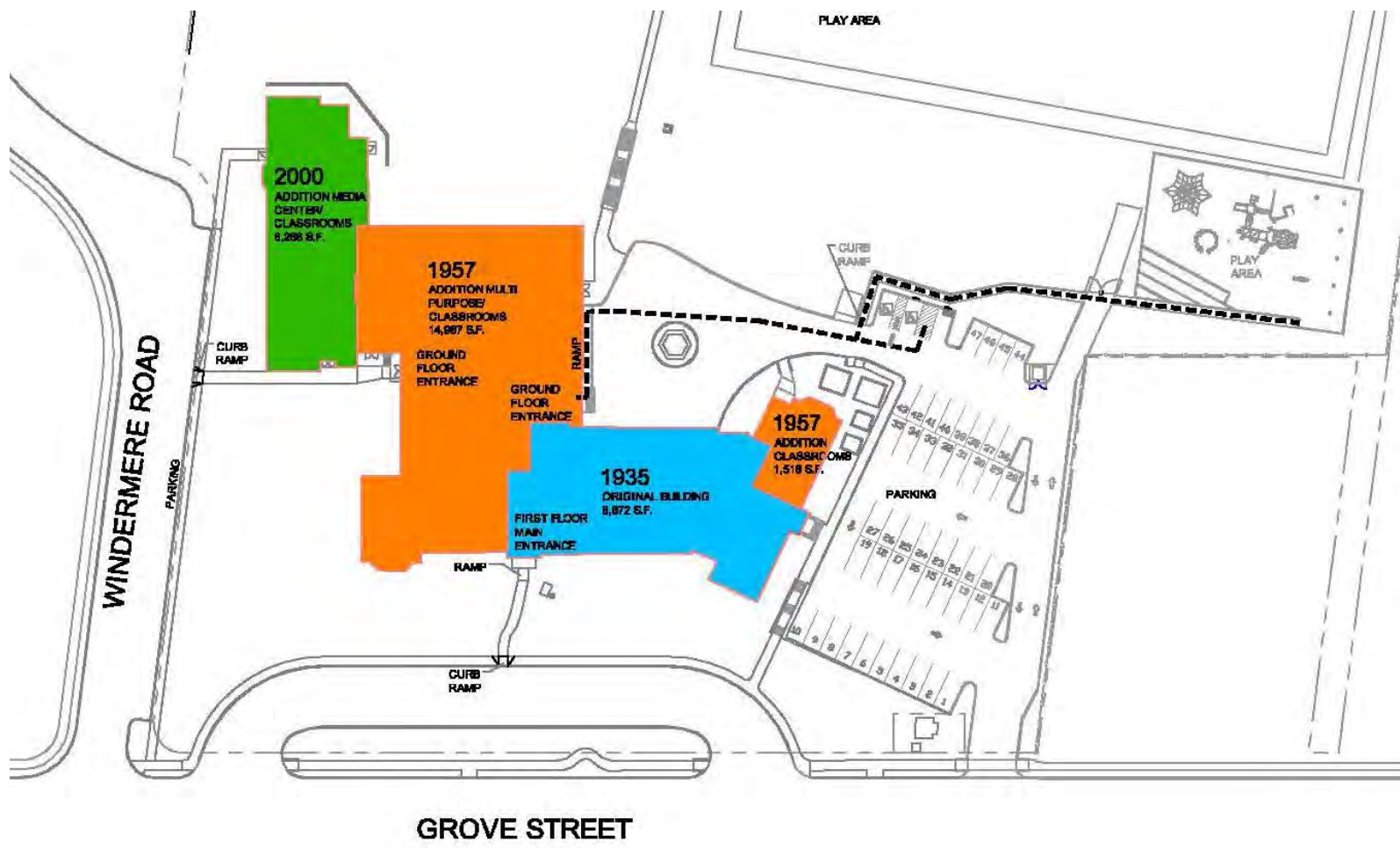

- Nishuane

Original Building -1908

Additions - 1917, 1923, 2002 (Elevator)

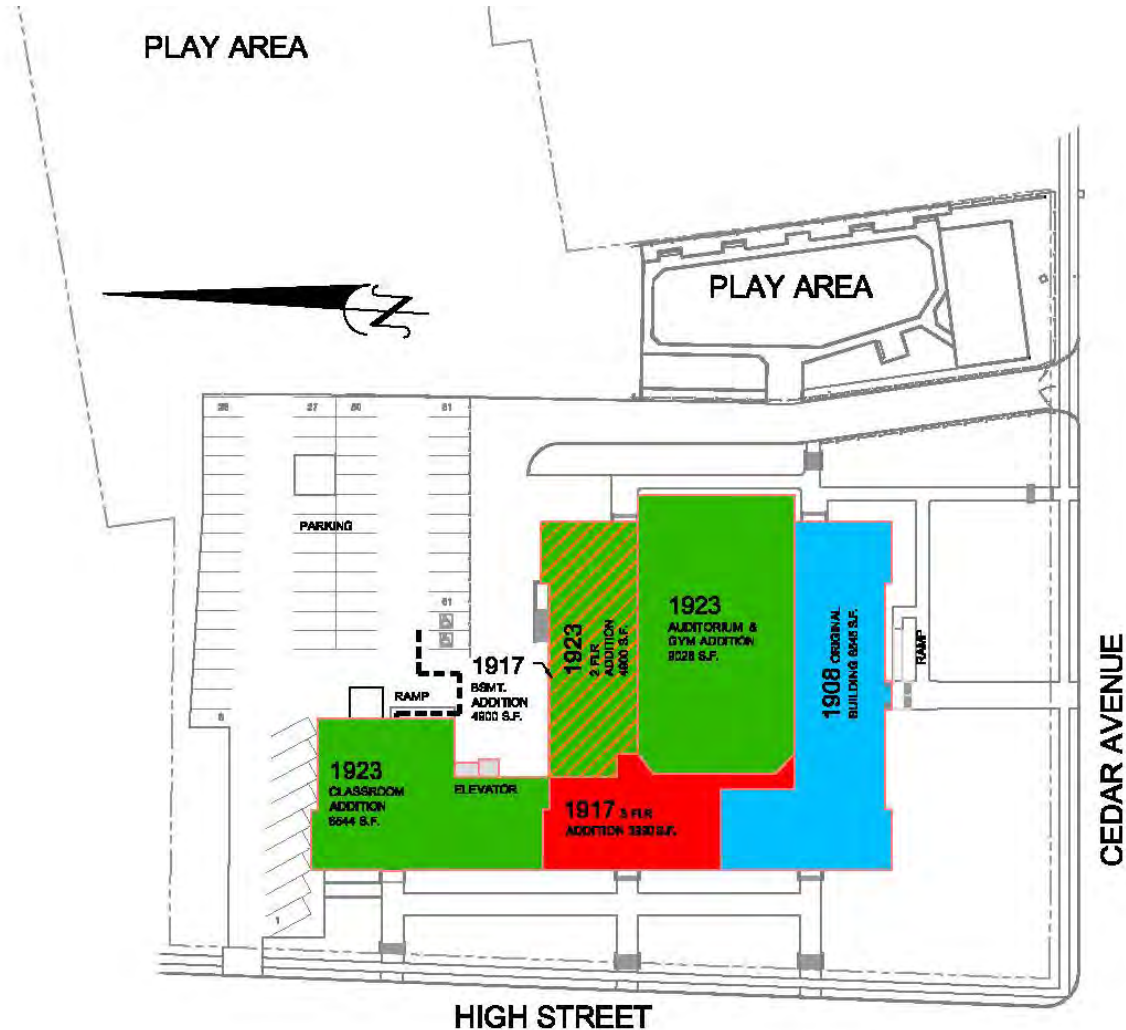

- Renaissance at Rand

Original Building -1924

Major alterations-1990, 1993

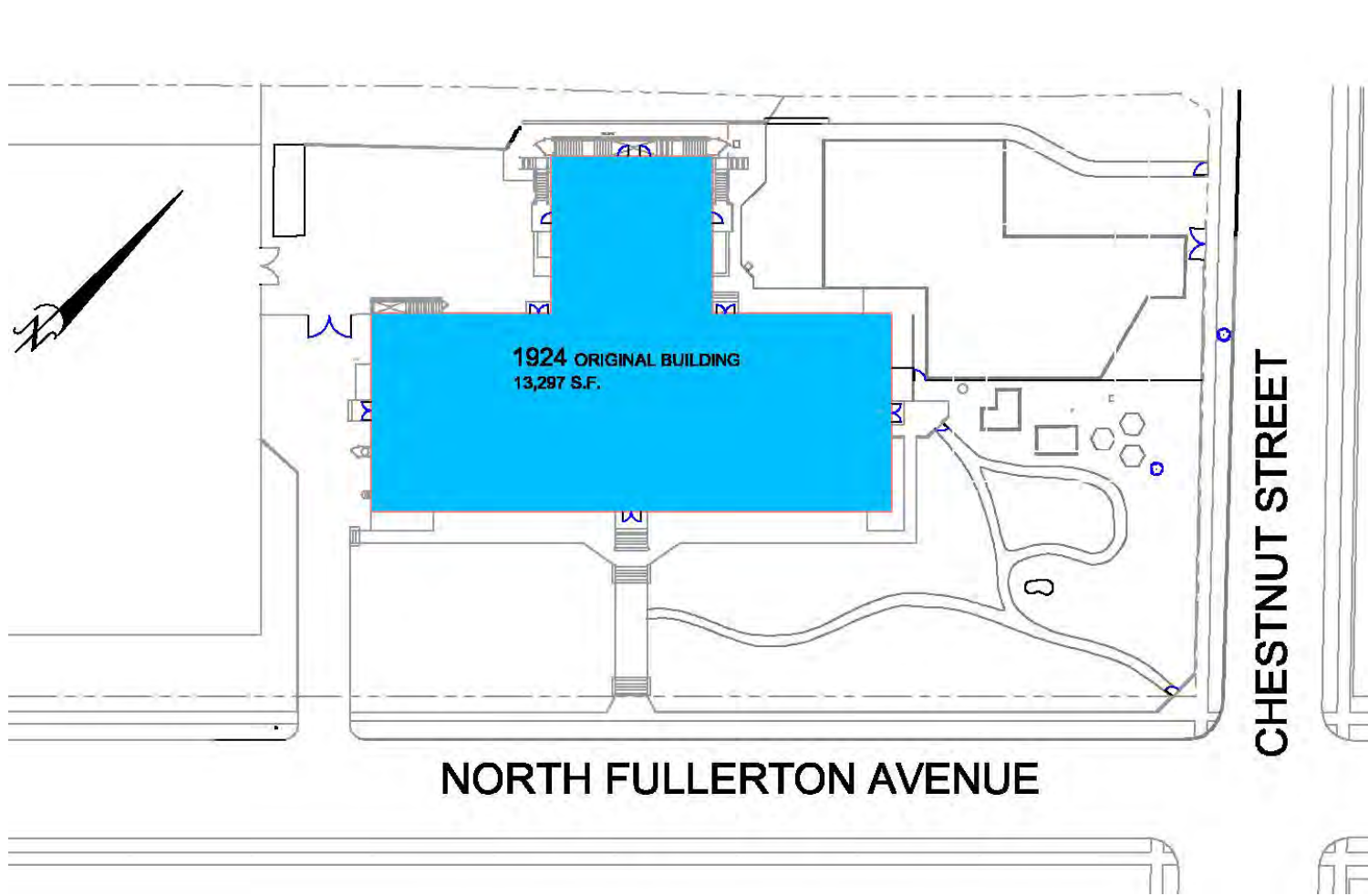

- Watchung

Original Building -1900

Additions - 1908, 1917, 1924, (Greenhouse- 2002)

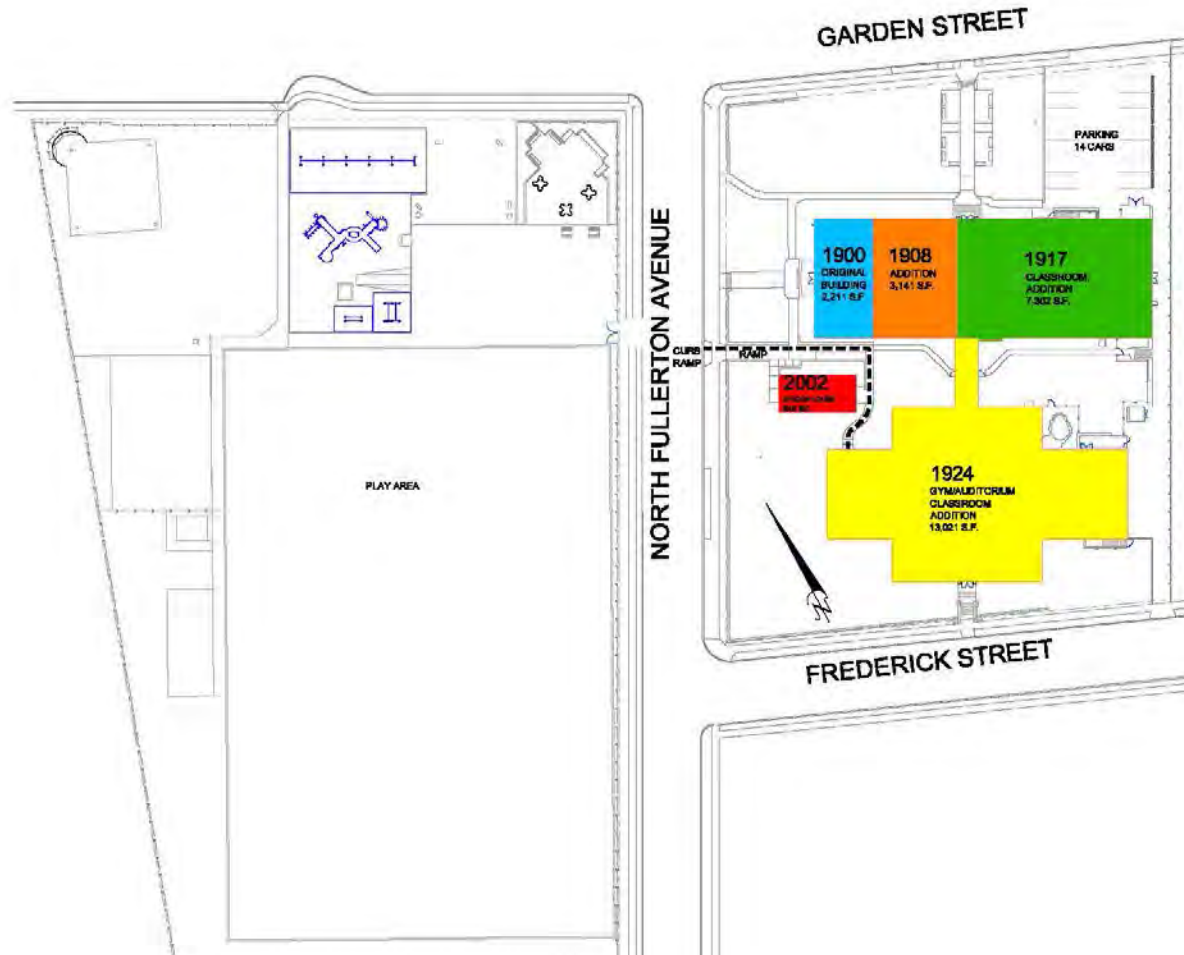

District Wide Boiler Information

- Boiler Installation Dates:

Building	Boiler #1	Boiler #2	Boiler #3	Boiler #4
Bradford	1988	2001		
Central Plant	2012	2013		
Charles Bullock	2010	2010		
Edgemont	1987	1987		
Furlong Field House	1994			
George Inness	1988	1988		
Glenfield	2014	2014		
High School		1981	1981	1988
Mt Hebron	1992	1992		
Nishuane	1987	1987		
Northeast	1987	1987		
Rand	1989	1989		
Watchung	1989	1989		

Playgrounds

- Bradford School: Installed with the addition 2005



- Edgemont School: Installed 1998



- Charles H. Bullock: Installed 2010:



- Hillside School: Installed 2002



- Nishuane School: Installed 1992

#1



#2



#3



- Northeast School: Installed 1992



- Watchung School: Installed 1996/2004:



- MCPK - Installed circa 1998



Playground Evaluation

- **Bradford School:**
 - Playground is in fair condition
- **Edgemont School:**
 - Playground is in fair condition - need to either remove or replace swings.
- **Charles Bullock School:**
 - Playground is in good condition
- **Hillside School:**
 - Playground is in fair condition

- Nishuane School:
 - Playground equipment #1 & 2 seem to be in fair condition.
 - Playground equipment #3 is showing signs of age and wear and tear.
- Northeast School:
 - Playground is in fair condition
- Watchung School:
 - Playground is in fair condition
- MCPK:
 - Playground is in fair condition
 - All Playground Equipment will be inspected by Guardian Gym Equipment within the next

DISTRICT WIDE ROOF SURVEYS

- Administration Complex:

	Area	Roof type	Installed	Warranty Expires	Contractor	Comment
AD	---	AspShgl	Circa 1970's	?	?	
PK	1	AspShgl	Circa 1970's	?	?	
PK	2	EPDM	Oct-1999	Oct-2009	Patwood	
PK	3	AspShgl	Circa 1970's	?	?	
PK	4	EPDM	Aug-2002	Aug-2012?	PennLyon Homes	Modular Building
CH	---	BUR	Circa 1930's	None	?	

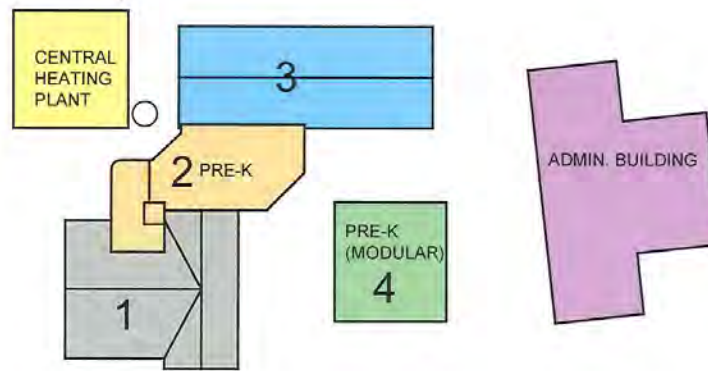

DRWG NO

PROJ NO
1251
MCRF

22 VALLEY
ROAD

SCALE: 1"=40'
DATE: 15 Mar 13
DRWN BY:
CHKD BY:

HARD RIGOLO ARCHITECT
1006 ST. A1 ROUTE 48, CLIFTON, N.J. 07013
(973) 778-1888 FAX: (973) 778-1888
www.hardrigolo.com
h.rigolo@hardrigolo.com

- Bradford School

Area	Roof type	Installed	Warranty Expires	Contractor	Comment
1	EPDM	Mar-2005	Mar-2025	Patwood	
2	EPDM	Dec-2010	Dec-2030	Northeast Roof	
3	EPDM	Aug-2012	Aug-2032	RVT Const	
4	Metal	Mar-2005	Mar-2025	Patwood	
5	Rbr Slate	Aug 2015	Aug-2065	Gen II	
6	EPDM	Dec-2010	Dec-2030	Northeast Roof	Perimeter "swale"
7	Metal	Sep-2012	Sep-2017	Northeast Roof	Entrance canopy

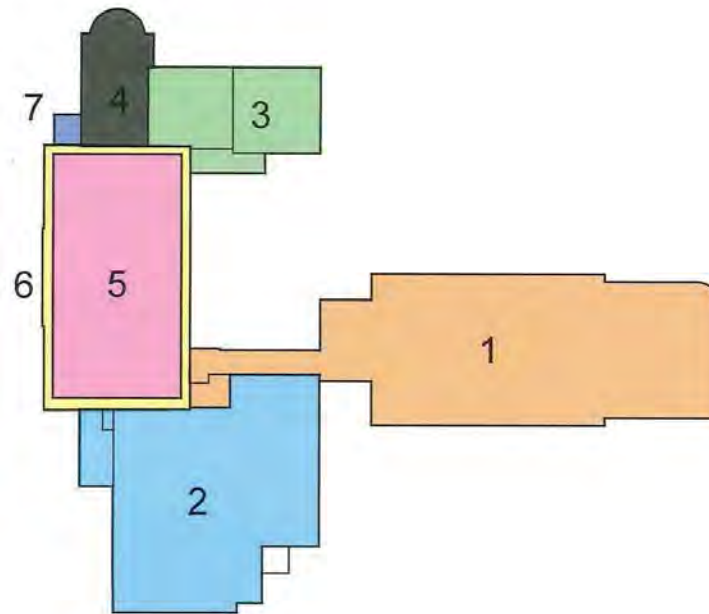

- Charles H. Bullock:

<u>Area</u>	<u>Roof</u> <u>type</u>	<u>Installed</u>	<u>Warranty</u> <u>Expires</u>	<u>Contractor</u>	<u>Comment</u>
1	EPDM	Jan-2010	Jan-2025	J Strober	

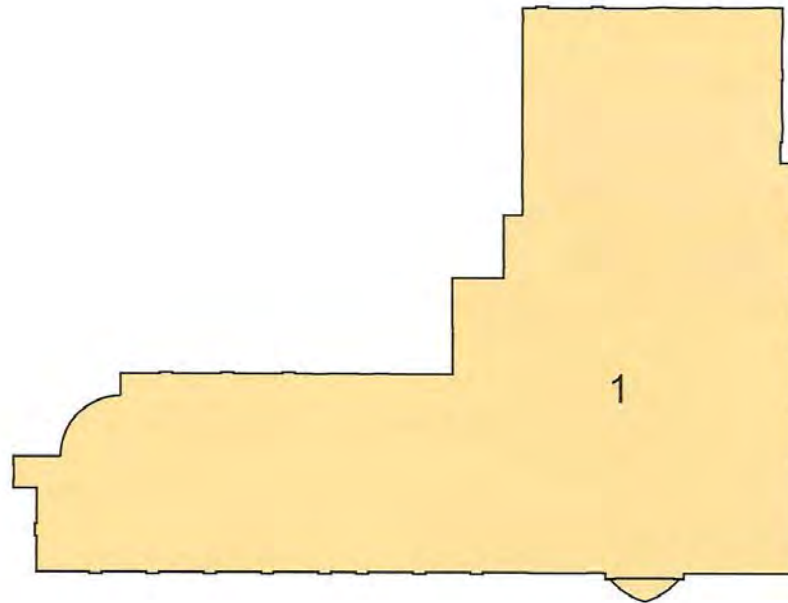

- Edgemont School:

Area	Roof type	Installed	Warranty Expires	Contractor	Comment
1	Rbr Slate	Aug 2015	Aug-2065	Billy Contracting	
2	EPDM	Sep-2011	Sep-2031	RVT Const	
3	EPDM	Dec-2008	Dec-2028	J Strober	
4	Rbr Slate	Aug 2015	Aug-2065	Billy Contracting	
5	Rbr Slate	Aug 2015	Aug-2065	Billy Contracting	
6	Copper	1926 est.	N/A	Original	Front entrance Portico
7	AspShel	Circa 1980's	?	?	Rear entrances

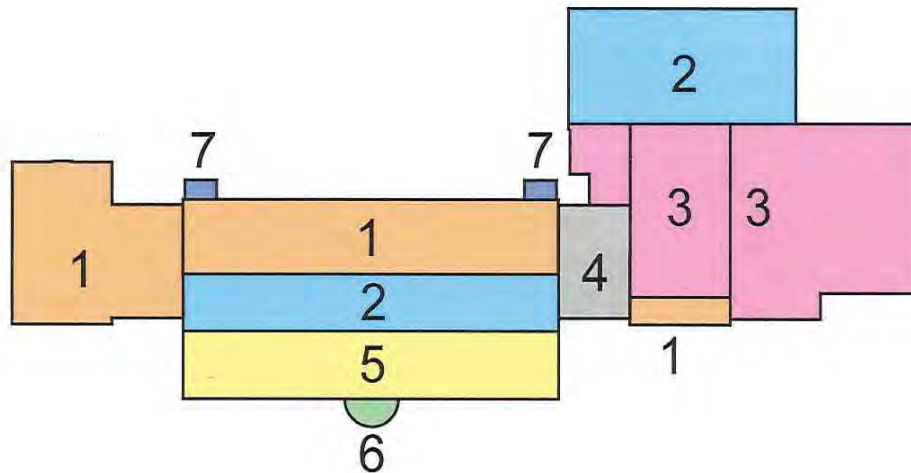

- Glenfield School:

Area	Roof type	Installed	Warranty Expires	Contractor	Comment
1	CemSlate	Jun-2001	Jun-2051	Best Rfng	
2	EPDM	Feb-2001	Feb-2011	Best Rfng	
3	RbrSlate	Mar-2006	Mar-2056	Murphy	
4	EPDM	Jun-2010	Jun-2030	Kraft	Courtyard over Tech Room
5	EPDM	Nov-2006	Nov-2026	Eastgate	
6	AspShgl	Jun-2001	Jun-2031	Best Rfng	
7	EPDM	Nov-2009	Nov-2029	Gen II	
8	EPDM	Mar-2013	Mar-2033	RVT Const	
9	EPDM	Dec-1990	Dec-2000	A & A Roofing	Over boiler room
10	BUR	1978 est.	?	?	Elevator hoistway

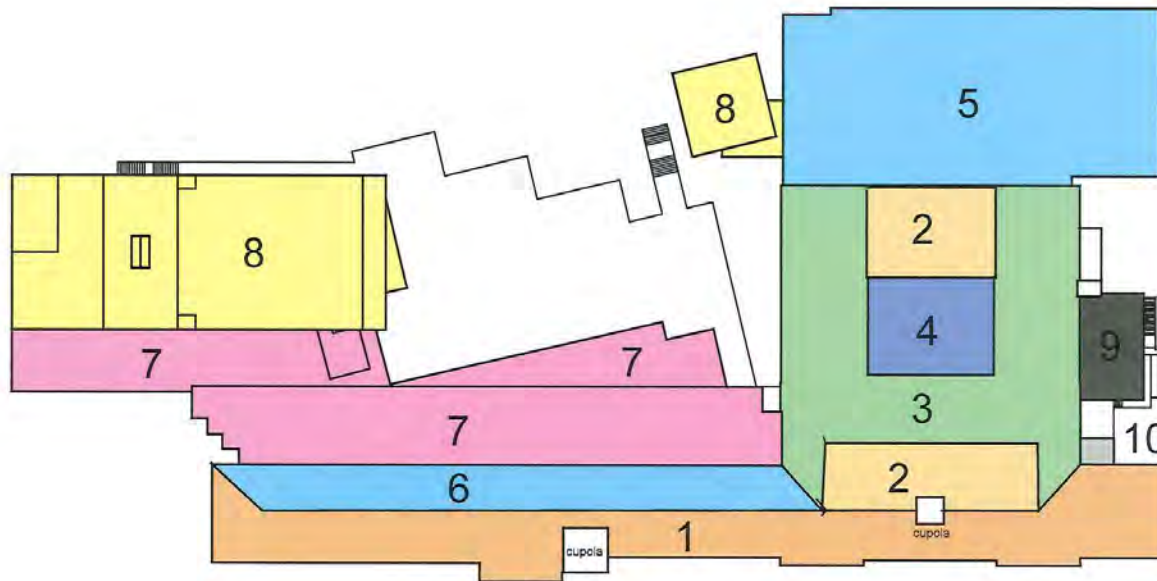

- George Inness Annex

Area	Roof type	Installed	Warranty Expires	Contractor	Comment
1	RbrSlate	Feb-2006	Feb-2056	Cipolini	
2	EPDM	Sep-2003	Sep-2018	Advanced Roofng	
3	Copper	Feb-2006	Feb-2011	Cipolini	
4	EPDM	Nov-2012	?	Northeast Roof ?	"Superstorm" Sandy repairs
5	EPDM	Dec-2008	Dec-2028	Kraft Roofing	
6	EPDM	Apr-2011	Apr-2016	Northeast Roof	Perimeter "swale"
7	Copper	1926 est.	N/A	—	Mechanical system inlet
8	EPDM	Feb-2006	Feb-2011	Cipolini	
9	EPDM	2000 est.	?	Northeast ?	Arranged by B & G ?
10	EPDM	Nov-2011	Nov-2026	RVT Const	Perimeter "swale"

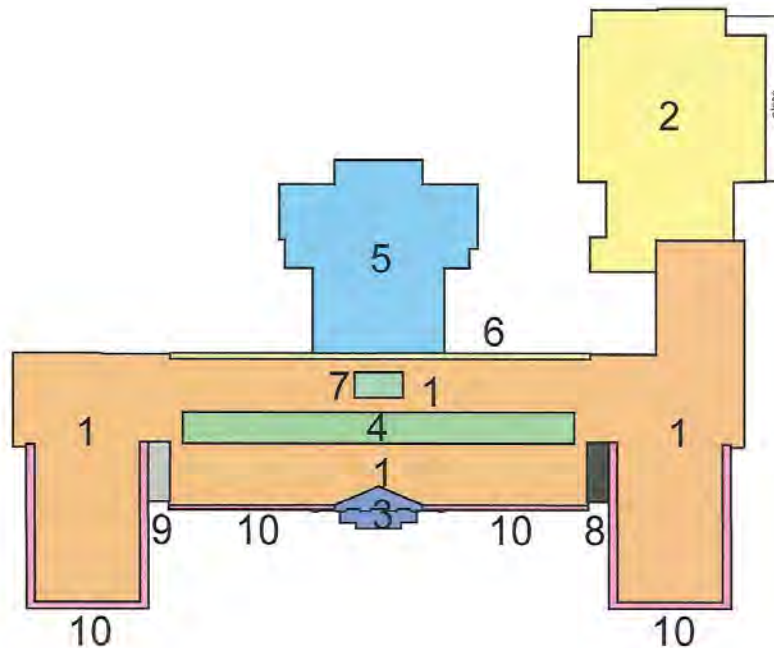

DRWG NO

PROJ NO
1251
MCRF

GEO. INNESS

SCALE 1"=60'
DATE 15 Mar 13
DRAWN BY:
CRD BY:

RICHARD RIGOLD ARCHITECT
151 GROVE ST. AT ROUTE 46, CLIFTON, N.J. 07013
TEL. (973)-776-8884 RICHARD RIGOLD, AIA
FAX. (973)-776-1898 N.J. 7201
EMAIL: rrigold@earthlink.net

DISTRICT ROOF
REPORT

- Montclair High School:

Area	Roof type	Installed	Warranty Expires	Contractor	Comment
1	EPDM	Dec-2008	Dec-2028	J Strober	
2	EPDM	Aug-2012	Aug-2032	Eastgate	Mechanical penthouses
3	EPDM	Apr-2011	Apr-2031	Kraft Roofing	
4	EPDM	Apr-2011	Apr-2031	Kraft Roofing	Gym Entrance canopy
5	EPDM	Aug-2011	Aug-2031	Eastgate	
6	EPDM	Nov-2006	Nov-2026	Eastgate	
7	EPDM	Sep 2013?	Sep 2033 ?	Patwood	Work to start summer 2013
8	EPDM	Apr-2011	Apr-2031	Kraft Roofing	
9	EPDM	Sep 2013?	Sep 2033 ?	Patwood	Work to start summer 2013

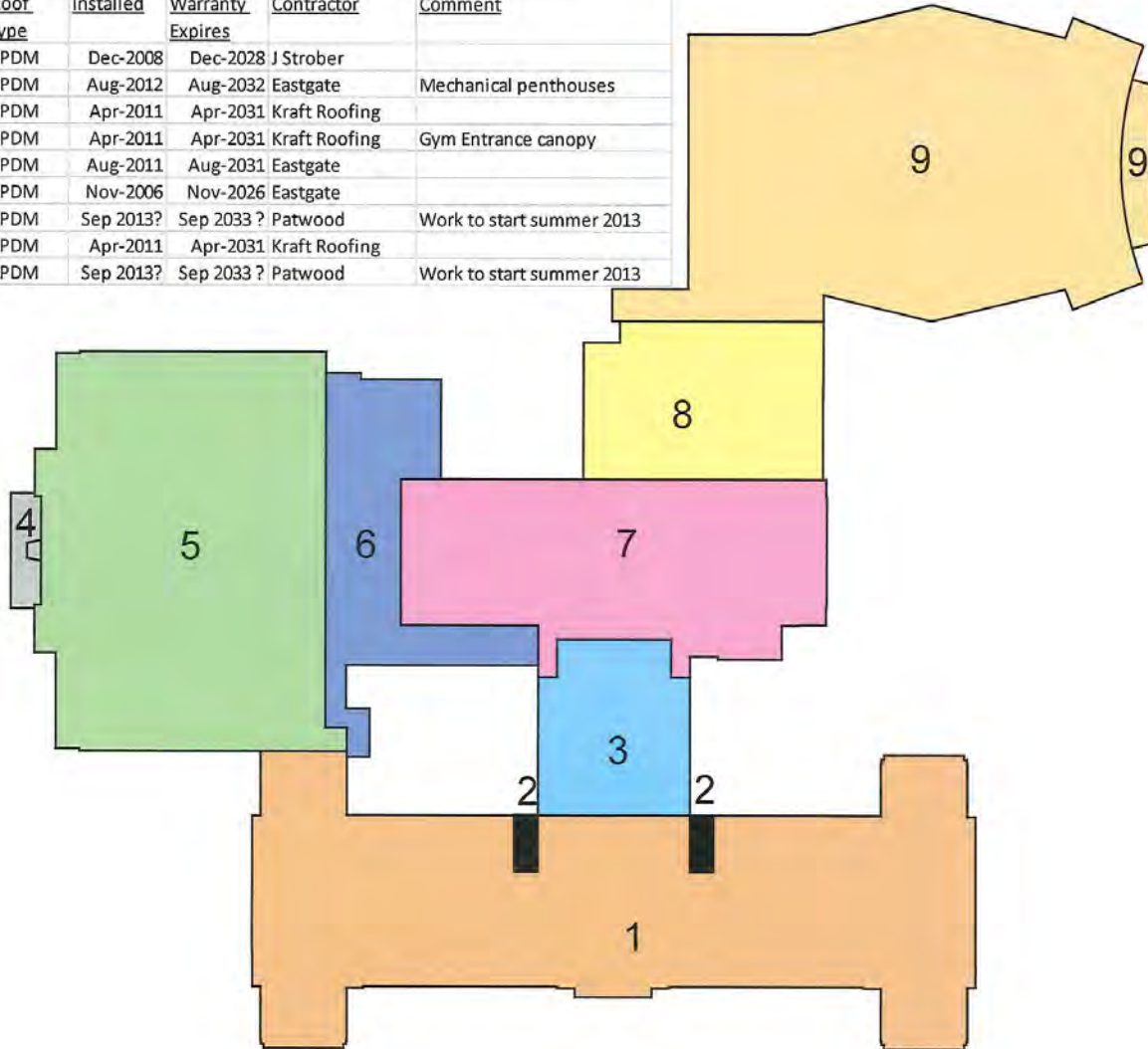

DRWG NO

PROJ NO
1251
MCRF

HIGH SCHOOL

SCALE: 1"=60'
DATE: 15 Mar 13
DRAWN BY:
CHD BT:

RICHARD RIGGIO ARCHITECT
151 GROVE ST. AT ROUTE 44, GAITHER, NJ 07033
TEL: (973)-779-8864
FAX: (973)-779-1868
WWW.RIGGIODISTRICTS.COM

DISTRICT ROOF
REPORT

- Fuzzy Furlong Field House:

<u>Area</u>	<u>Roof</u> <u>type</u>	<u>Installed</u>	<u>Warranty</u> <u>Expires</u>	<u>Contractor</u>
1	AspShgl	2008 est.	2033?	J Strober
2	EPDM	Dec-2008	Dec-2028	J Strober

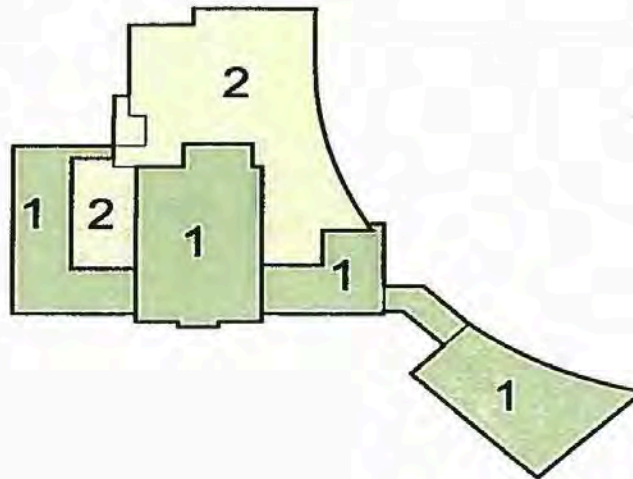

- Hillside School:

Area	Roof type	Installed	Warranty Expires	Contractor	Comment
1	EPDM	Pre 1986	1996 ?	?	
2	EPDM	Jun-1988	Jun-1998	McCulloch Rfng	
3	EPDM	Oct-2004	Oct-2019	Patwood	
4	EPDM	Oct-2005	Oct-2025	Patwood	
5	EPDM	Mar-2004	Mar-2019	Patwood	Elevator hoistway & Mech Rm



DRWG NO

PROJ NO
1251
MCRF

HILLSIDE

SCALE: 1"=40'
DATE: 15 Mar 13
DRAWN BY:
CHKD BY:

RICHARD RIGOLO ARCHITECT
151 GROVE ST. AT ROUTE 45, DUFREN, VA, 07013
TEL: (973)-778-6884 RICHARD.RIGOLO, AIA
FAX: (973)-778-6884
EMAIL: rrigolo@rarch.com

DISTRICT ROOF
REPORT

- Mt Hebron School:

Area	Roof type	Installed	Warranty Expires	Contractor	Comment
1	RbrSlate	Dec-2007	Dec-2057	Patwood	
2	EPDM	Dec-2007	Dec-2027	Patwood	
3	RbrSlate	Nov-2008	Nov-2058	Fulton	
4	EPDM	Oct-2008	Oct-2028	Fulton	
5	AspShgl	Jan-2008	Jan-2033	Fulton	
6	EPDM	Nov-2010	Nov-2030	Gen II	
7	BUR	1973 est.	?	?	Elevator hoistway
8	EPDM	Aug-2001	Aug-2011	Canella Roofing	Greenhouse

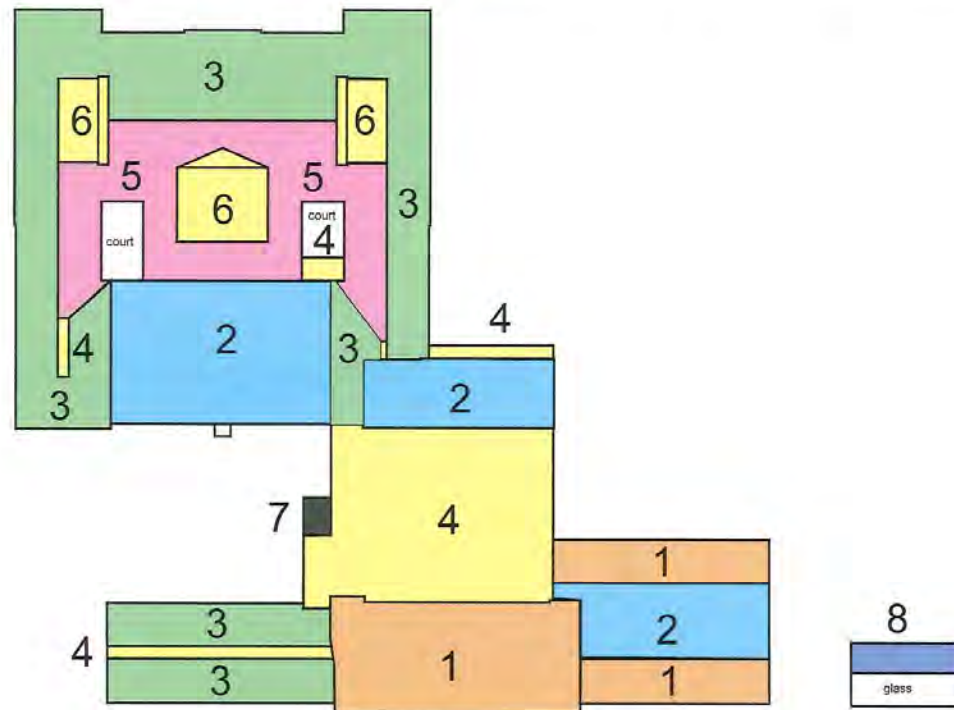

DRWG NO
 PROJ NO
 1251
 MCRF
 MT HEBRON
 SCALE: 1"=60'
 DATE: 15 Mar 13
 DRWN BY:
 CHD BT:
 RICHARD RIGOLD ARCHITECT
 151 ORANGE ST. AT ROUTE 6A GAITHERSBURG, MD 20878
 TEL (301) 778-6864 RICHARD RIGOLD, AIA
 FAX (301) 778-1868 NLS 7201
 EMAIL: rrigold@rra.net
 DISTRICT ROOF
 REPORT

- Nishuane School:

Area	Roof type	Installed	Warranty Expires	Contractor	Comment
1	EPDM	Sep-2007	Sep-2027	Patwood	
2	EPDM	Aug-1987	Aug-1997	ER Barret	
3	EPDM	Aug-2002	Aug-2007	Pace Builders	Elevator hoistway & Mech Rm
4	AspShgl	Sep-1988	?	Montclair BOE	Canopy over ramp

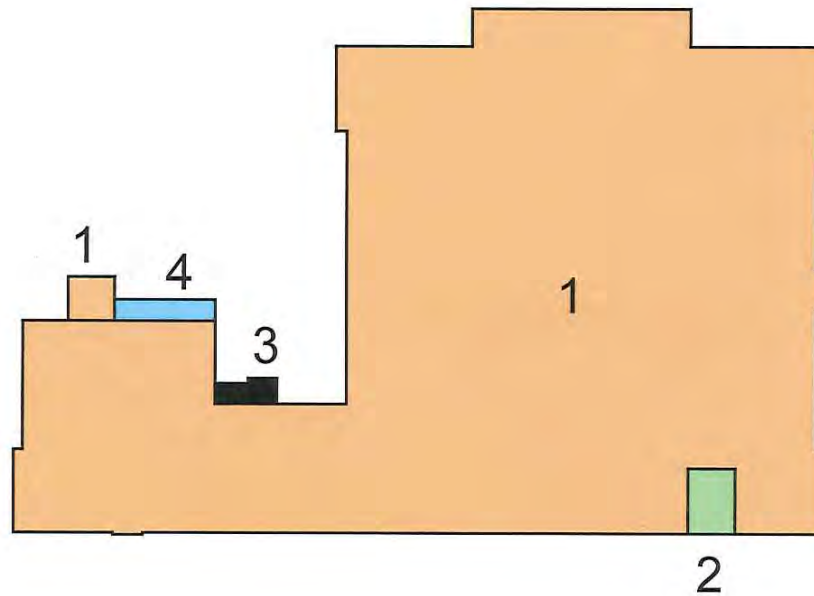

- Northeast School:

Area	Roof type	Installed	Warranty Expires	Contractor
1	Slate	1935, 1937	None	?
2	EPDM	Nov-2005	Nov-2025	Patwood
3	AspShgl	Circa 1990's	?	?
4	EPDM	Dec-2010	Dec-2030	Northeast Roof
5	EPDM	Sep-2000	Sep-2010	Advanced Roofng
6	CemSlate	Dec-2000	Dec-2050	RK Roofing

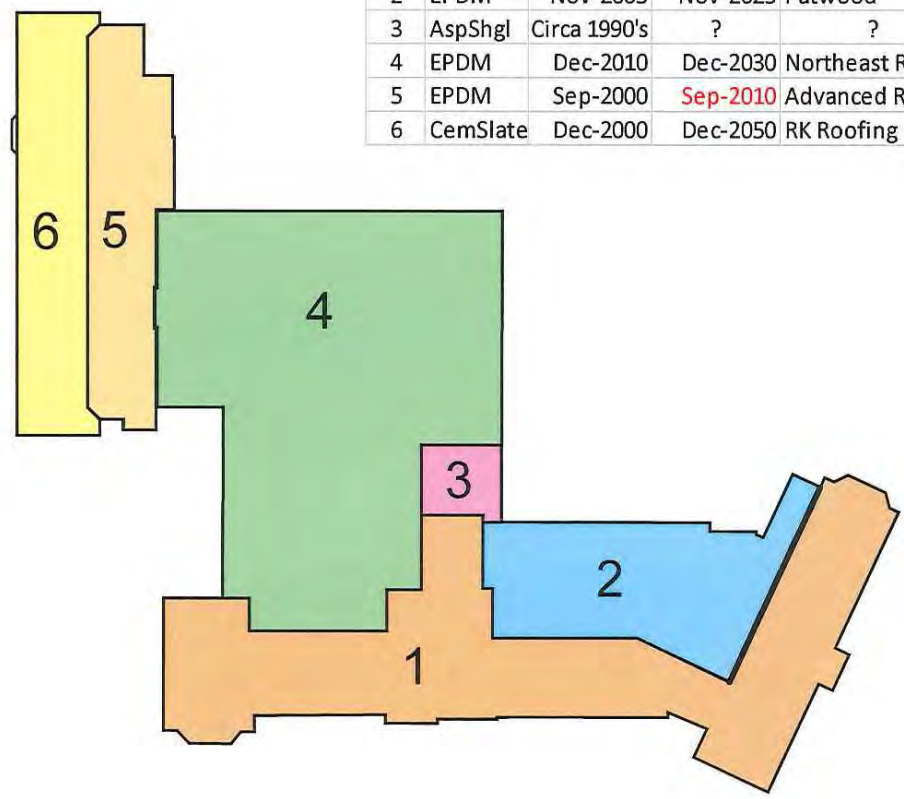

- Renaissance School at the Rand Building:

NOTE: Shed roof was replaced this summer.

<u>Area</u>	<u>Roof type</u>	<u>Installed</u>	<u>Warranty Expires</u>	<u>Contractor</u>	
1	EPDM	Oct-1997	Oct-2007	Barbuto Roofing	

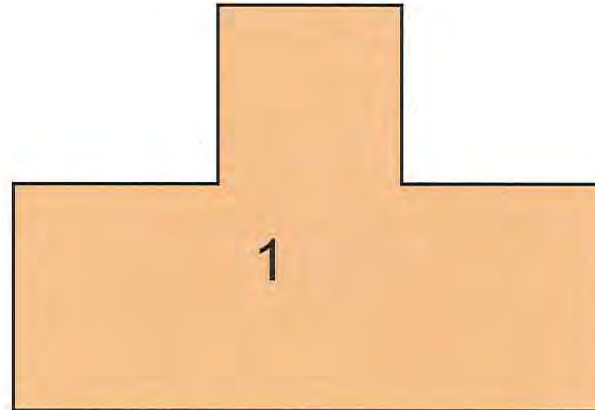

- Watchung School:

Area	Roof type	Installed	Warranty Expires	Contractor	Comment
1	EPDM	Dec-2008	Dec-2028	Kraft Roofing	
2	EPDM	Sep-2011	Sep-2031	RVT Const	
3	EPDM	Circa 1980's	?	?	Entrance canopy

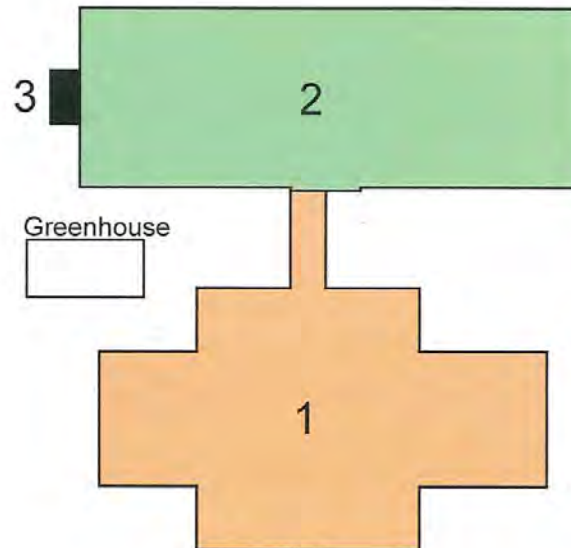

Parking Lot Information

- Bradford:
 - Small parking lot on College Ave in fair condition
 - Parking lot in rear needs small patch by dumpster and cracks to be filled.
- Charles H. Bullock:
 - Parking lots needs cracks to be filled.

- Edgemont School:
 - Front circle in poor condition.
 - Rear parking lot fair condition
- Glenfield School:
 - Circle in fair condition.
 - Side parking lot by Park in good condition.
- George Inness Annex:
 - Rear parking lot needs crack filling.
 - Small patches required.
 - Re-line parking lot
 - Front circle black top needs to be patched or replaced.

- High School:
 - Auditorium Circle brand new Township paved auditorium circle.
 - Front circle in poor condition needs to re-paved
 - Rear Parking lot needs to be re-paved.
- Hillside School:
 - Parking lot needs crack filling and
 - Catch basin in rear parking lot replaced/repared.
- Mt Hebron:
 - Rear parking lot re-paved
 - Side parking lot fair condition

- Nishuane School:
 - Rear parking lot needs to be re-paved
- Northeast School:
 - Front circle in good condition
 - Rear parking lot needs crack filling and entrance of driveway needs to be patched.
- Renaissance School @ Rand Building:
 - Driveway and parking lot needs to be replaced.

- Watchung School:
 - Side parking lot in fair condition need cracks filled.
 - Side driveway in fair condition.
- Woodman Field Complex:
 - Circle in fair condition.
 - Parking lot in fair condition.